

# Sound Acoustics

Premium Residential & Commercial Audio/Video Products



## **PRO-RVC** **REMOTE LINE / MIC MIXER**

### **Owner's Manual**

## Introduction

Congratulations and thank you for purchasing a Sound Acoustics product. The PRO-RVC is a stand alone flush wall mounted microphone/line mixer that can operate independently or with Sound Acoustics amplifiers. The PRO-RVC is perfect for adding extra inputs to an audio system with remote control of mix balance and master volume control. Please read this entire manual to get the most from your Sound Acoustics PRO-RVC.

## Includes:

- 1 x PRO-RVC mic/line mixer
- 2 x Mounting Screws
- 1 x Installation manual
- 3 x Knob security covers

## Connecting to Sound Acoustics Amplifiers:

Ensure the amplifier is powered off and unplugged from the wall ac outlet before making connections.

Carefully unpack the PRO-RVC.

Run a Cat5, Cat5e or Cat6 cable from the amplifier to the PRO-RVC location.

Terminate the wire in a single gang electrical box or use a drywall mud ring at the PRO-RVC location.

**Caution:** Ensure the connections (pinnings) are exactly the same at both ends of the cable. See diagram below.

## MODEL PRO-RVC

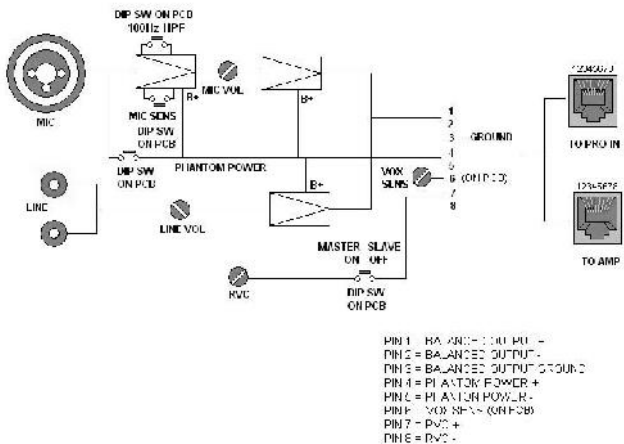

The back panel of the PRO-RVC provides two RJ45 female jacks. OUT1 (to amplifier) and IN1 (from additional PRO-RVC's) Push the connector/cable into the jack until the jack clicks and is seated firmly. All Sound Acoustics amplifiers provide a back panel RJ45 female jack for connecting the PRO-RVC. When using multiple PRO-RVC's (max 3) connect the OUT1 from PRO-RVC # 2 to the IN1 of the first PRO-RVC and repeat for PRO-RVC #3. See the following diagram.

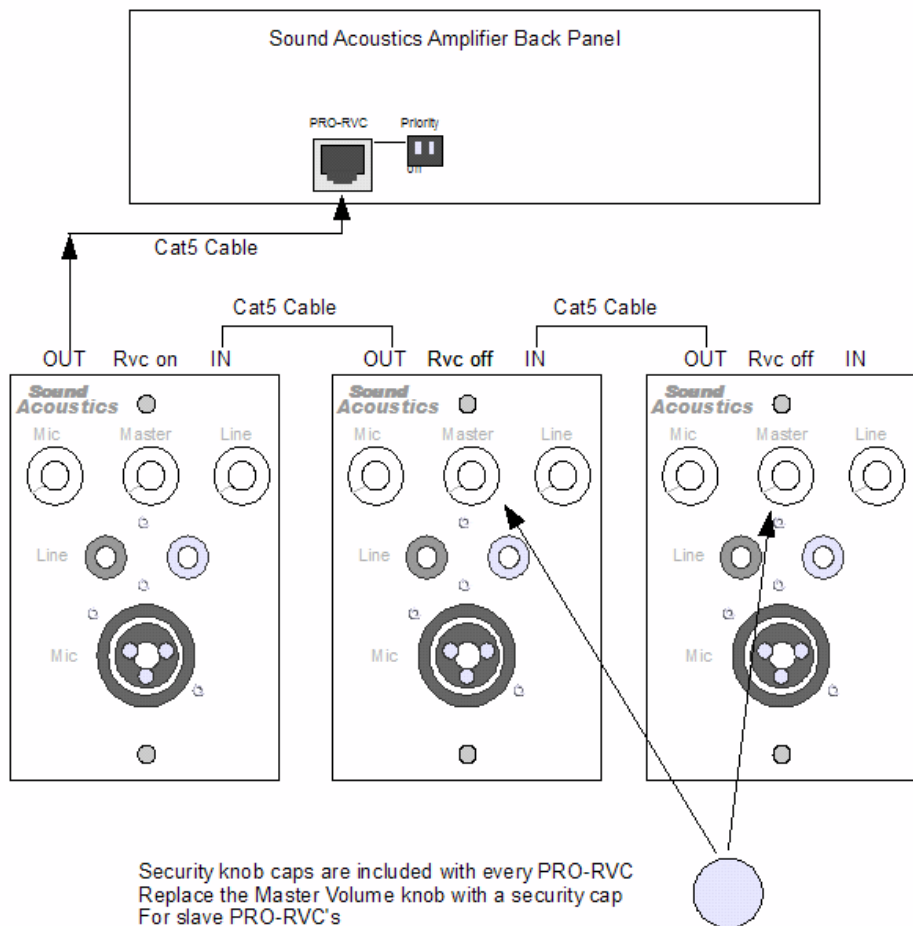

### Connecting to Non Sound Acoustic Amplifiers:

It is possible to use the PRO-RVC with other manufacturers amplifiers, mixers and receivers.

Follow the steps listed above and install the optional RVC-ADAPT between the master PRO-RVC and the amplifier.

The RVC-ADAPT converts the RJ45 output of the PRO-RVC to individual line level output, phantom power and master volume control. Connect the RVC-ADAPT power supply.

Connect the RVC-ADAPT output to an unused line level input on the mixer, amplifier or receiver. Some commercial amplifiers also include a remote master volume contact that can be controlled from the RVC-ADAPT RVC output.

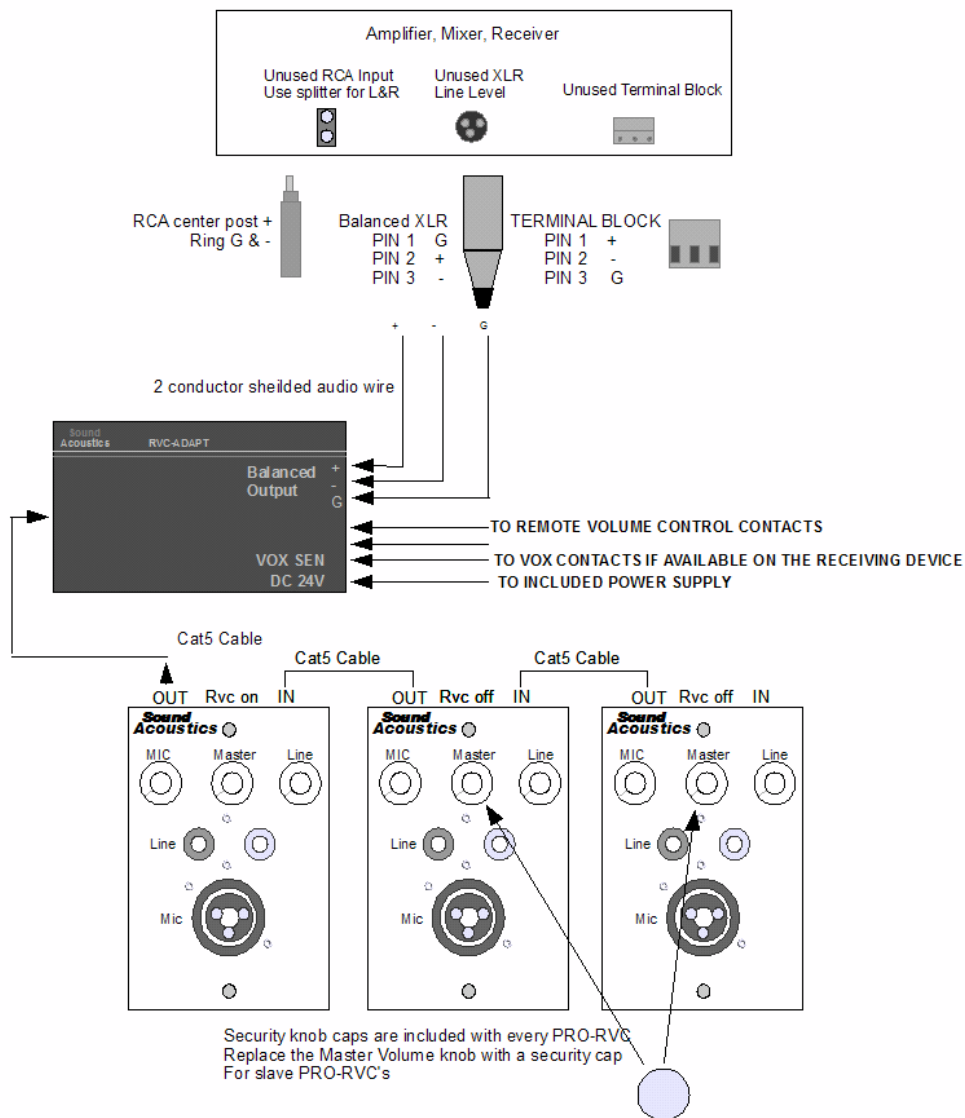

## Operation:

**NOTE:** The PRO-RVC is a powerful microphone/line amplifier. Always start with the volume controls off (turned fully counter clockwise) and adjust slowly. This will avoid feedback and possible damage to the amplifier and loudspeakers. Once up to 3 PRO-RVC's are properly connected, re-connect the AC power cord of the amplifier to the AC wall outlet and power the amplifier ON. Always start with the PRO-RVC volume controls turned all the way down counter clockwise. Turn the amplifier master volume control to 2/3rds full.

Connect a microphone into the microphone input jack on the PRO-RVC. Turn the master volume control up to 12:00 50% full.

Slowly turn the microphone volume control up while speaking into the microphone until you reach the desired volume level. Repeat the same procedure for the dual RCA jacks with a CD, DVD or other music source.

## **Automatic Override**

**Momentary Override:** Sound Acoustics amplifiers provide a back panel priority switch. Set the priority switch to ON to momentarily override all other sources plugged into the amplifier.

**Constant Override:** Sound Acoustics amplifiers provide a back panel MUTE connection. Use this to constantly override all other sources connected to the amplifier (does not effect the TEL or priority inputs). This prevents other sources from being broadcast between music passages or spoken word phrases. Connect a switch or use contact closure to the MUTE contacts. This can be installed at the PRO-RVC location allowing remote control of the override feature.

## **Specifications:**

Frequency Response: 20Hz – 20kHz

Signal – Noise Ratio Microphone: 70dB

Signal – Noise Ratio Line: 80dB

Power Requirements: 24V DC (Not required when using with Sound Acoustic Amplifiers)

Dimension Face Plate: W 70mm x H 150mm x D 50mm / W 2.75" x H 5.9" x D 1.96"

(Depth Fits Single Gang Electrical Boxes)

Shipping Weight: 0.45 kg / 1 lb

## **Contact Information**

Sound Acoustics HQ

1360 Frances Street

Vancouver BC Canada V5L 1Y9

E-mail: [info@mysoundacoustics.com](mailto:info@mysoundacoustics.com)

Website: [www.mysoundacoustics.com](http://www.mysoundacoustics.com)

## **Warranty**

The Sound Acoustics PRO-RVC is warranted to be free from defects in workmanship and materials for a period of three (3) years without charge for parts or labour. The warranty applies only to the original owner. The owner's responsibilities are to provide proof of purchase and transportation to the dealer the unit was purchased from or transportation to the Sound Acoustics factory. This warranty does not apply to units which have been subject to misuse, abuse, neglect or improper installation, and does not apply to repairs or alterations by unauthorized personnel. This warranty specifically excludes responsibility for consequential damage.

Retention of your dated ORIGINAL BILL OF SALE is required to obtain service under the terms of the warranty.